

POONAMALLI BYPASS

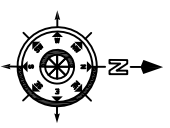

CHENNAI DISTRICT
MADURAVOYAL TALUK
KARAMBAKKAM TOWN
CORRIDOR NO.4 - 22.CHENNAI BYPASS CROSSING
AT CHAINAGE - 18054.0m

LIGHT HOUSE



SCALE:- 1:1000

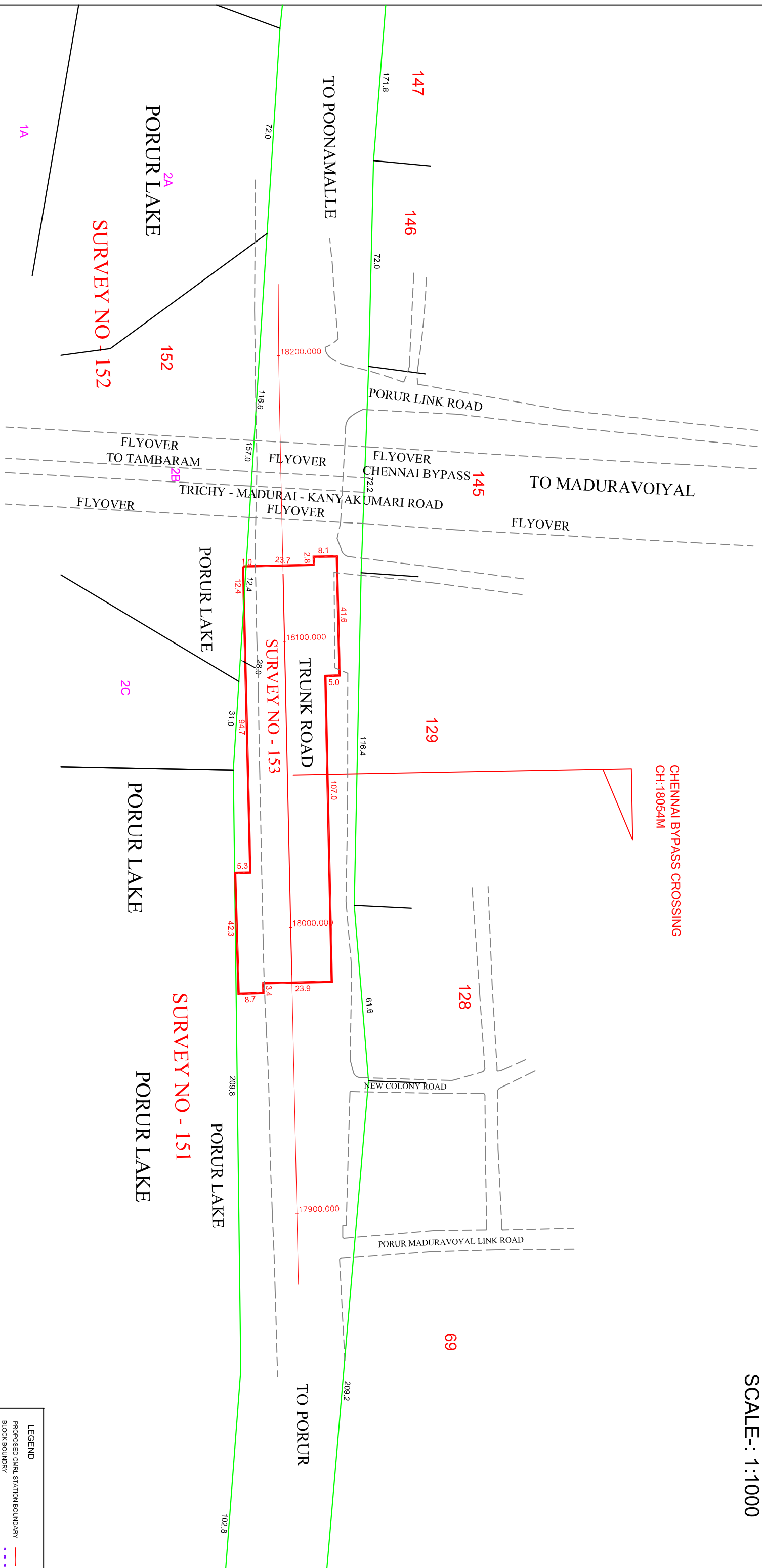

LEGEND

- PROPOSED CMRL STATION BOUNDARY
- BLOCK BOUNDARY
- FIELD BOUNDARY
- ROAD AND STREET BOUNDARY

<p>CHENNAI METRO RAIL LIMITED</p> <p>Admin Building, CMRL Depot, Kodambakkam High Road, Kodambakkam, Chennai - 600 037 Tel: 044-26233220, 26233220 Email: chennai@cmrl.com</p>		<p>CHENNAI METRO RAIL PROJECT PHASE - II</p> <p>TITLE : 22.CHENNAI BY PASS CROSSING</p>	
<p>PRIME CONSULTANT:</p> <p>Prime Meridian Surveys Private Limited., New No. 896 (Old No. 638), Madhavraj Apartment, Jones Road, Sholingur, Chennai - 600 072, 23813988, Email: info@prime-survey.com</p>		<p>DESIGNED/DRAWN: R.K</p>	
<p>GENERAL NOTES: 1. ALL DIMENSIONS ARE IN METERS UNLESS OTHERWISE NOTED.</p>		<p>CHECKED: G. Siva</p>	
<p>REV. DATE DESCRIPTION</p>		<p>DRAWING NAME: LAND PLAN SCHEDULE</p>	
<p>CGM (G/S) - CMRL</p>		<p>DRAWING NUMBER: PMSPL/CMRL PIVCOR 4 EXT/STN/LS/22</p>	
<p>SCALE: 1:1000</p>		<p>DATE: 30-1-2018</p>	