

MADHAVARAM

SIRUSERI

19.GEMINI
VILLAGE NAME - NUNGAMBAKKAM

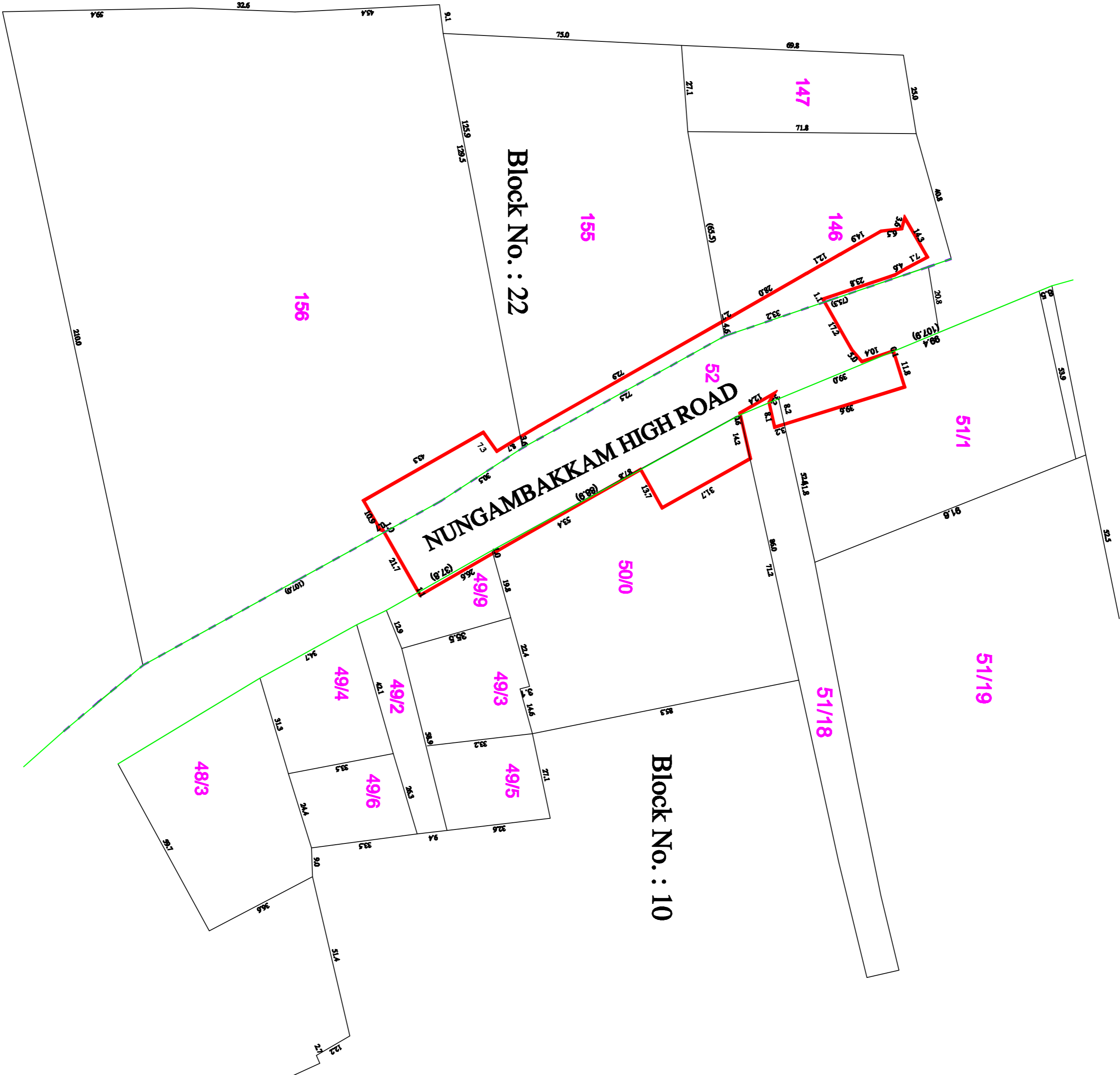
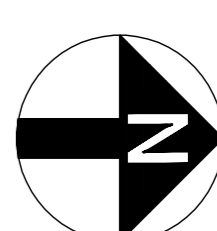

LEGEND

- PROPOSED CMRL STATION BOUNDARY
- BLOCK BOUNDARY
- FIELD BOUNDARY
- ROAD BOUNDARY

CLIENT:
CHENNAI METRO RAIL LIMITED
 Adina Building, CMRL Depot,
 Poovampalayam High Road,
 Koyambakkam, Chennai - 600 107.
 Ph: 044-23782000, Fax: 044-23782200.
 Email: chennai@metrocmrl.com

SURVEY CONSULTANT:
Prime Meridian Surveys Private Limited,
 New No. 69/6 (Old No. 63/6),
 Madhavaram Apartment, Jones Road,
 Sulliyapatti, Chennai - 600 015.
 Ph: 044-23813888, Fax: 044-23813889.
 Email: meridian@prime.com

GENERAL NOTES:
 1. ALL DIMENSIONS ARE IN METERS UNLESS OTHERWISE NOTED.
 The drawing is the property of Chennai Metro Rail Limited and shall not be used for any purpose other than that intended without the written consent of Chennai Metro Rail Limited.

REV. DATE

DESCRIPTION

CGM (UG) - CMRL

DESIGNED BY:
 CHECKED:
 G.SVB

TITLE :
CHENNAI METRO RAIL PROJECT PHASE - II
 GEMINI
 DRAWING NAME:
LAND PLAN SCHEDULE
 DRAWING NUMBER:
PMSP/CMRL/P11/COR 3/STN/LP/26
 SHEET NO. 1 of 1
 SHEET SIZE A1
 SCALE 1:1000
 DRAWN DATE: 14-12-2017