

POONAMALLI BYPASS

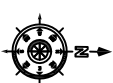

CHENNAI DISTRICT
MAMBALAM TALUK
SALIGRAMAM TOWN
CORRIDOR NO.4 - 15.SALIGRAMAM
AT CHAINAGE 11743.0m

LIGHT HOUSE



SCALE 1:1000

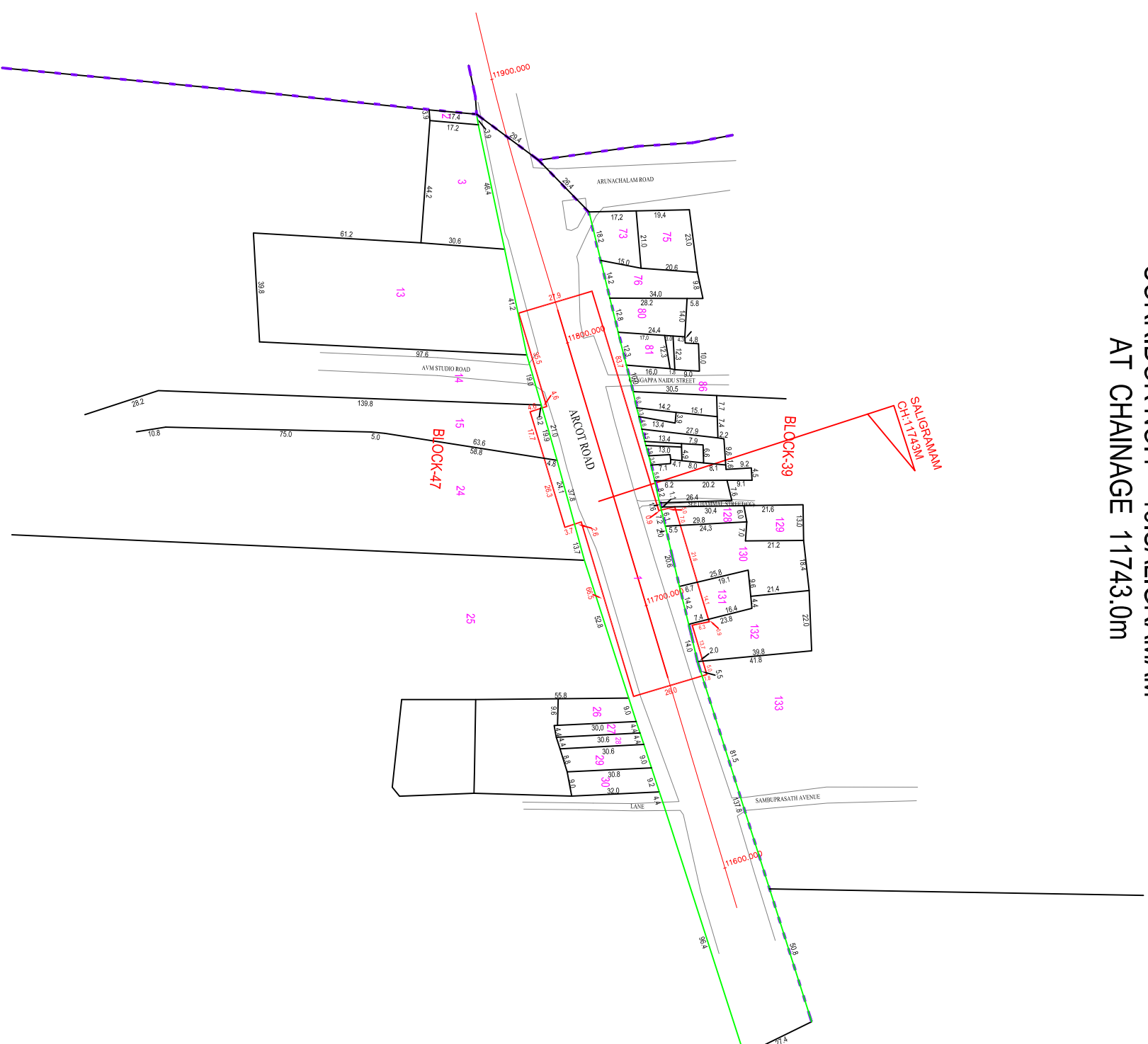

LEGEND:-

- PROPOSED CMRL STATION BOUNDARY
- BLOCK BOUNDARY
- FIELD BOUNDARY
- ROAD AND STREET BOUNDARY

CLIENT :		CHENNAI METRO RAIL LIMITED	
SURVEY CONSULTANT :		Prime Meridian Surveys Private Limited.,	
GENERAL NOTES:		1. ALL DIMENSIONS ARE IN METER, UNLESS OTHERWISE NOTED.	
REV.		DATE	
DESCRIPTION		DRO - CMRL	
DESIGNED/DRAWN		R.P.S	
TITLE :		CHENNAI METRO RAIL PROJECT PHASE - II	
DRAWING NAME:		15.SALIGRAMAM	
DRAWING NUMBER:		LAND PLAN SCHEDULE	
DRAWING NUMBER:		PMSPL/CMRL/PI/COR 4/COMILPS/15	
SHEET NO		SHEET SIZE	
1 of 1		A1	
SCALE:		SCALE:	
1 : 1000		1 : 1000	
DRAWN DATE:		DRAWN DATE:	
20-02-2019		20-02-2019	

Admin Bldg, CMRL Dept,
Poonamalli High Road,
Koyambettu, Chennai - 600 107
Ph: 044-2329200, Fax: 044-2329200,
Email: chennaiadmin@cmrail.com

New No. 69B/CM No. 69B,
Medanagar Apartment, Jones Road,
Sallepeta, Chennai - 600 015,
Ph: 044-2313988, Fax: 044-2313988,
Email: meridianpsurvey@gmail.com

"This block is the property of Chennai Metro Rail Limited and it shall be handed to the project of CMRL as per the terms and conditions of the contract and shall be used for the purpose of the project only."

