

# STATION NO.11.KODAMBAKKAM SUBURBAN (Village-T.Nagar)

LIGHT HOUSE  
↑

KOYAMBEDU  
↓

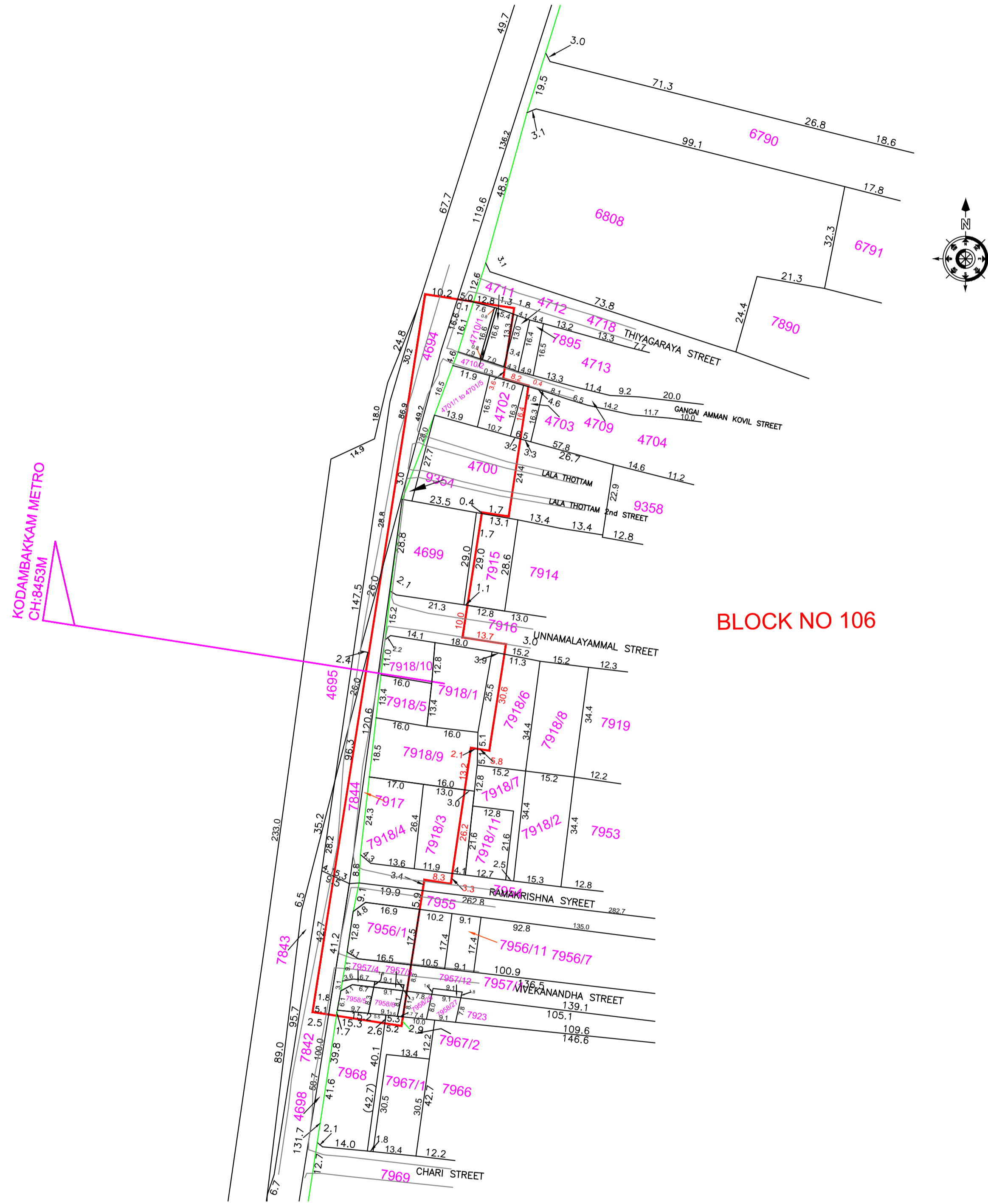

LEGEND	
PROPOSED CMRL STATION BOUNDARY	— (Pink line)
BLOCK BOUNDARY	— (Red line)
FIELD BOUNDARY	— (Black line)
ROAD AND STREET BOUNDARY	— (Green line)

CLIENT : <b>CHENNAI METRO RAIL LIMITED</b> Admin Building, CMRL Depot, Poonamallee High Road, Koyambedu, Chennai - 600 107. Ph: 044-23792000, Fax: 044-23792200. Email- chennaiMetroRail@gmail.com	SURVEY CONSULTANT : Prime Meridian Surveys Private Limited., New No. 68/6, (Old No. 63/6), Madhangai Apartment, Jones Road, Saidapet, Chennai - 600 015. Ph: 044-23813668, Fax: 044-23813669. Email- meridian-surveys@gmail.com	GENERAL NOTES : 1. ALL DIMENSIONS ARE IN METER, UNLESS OTHERWISE NOTED.	DESIGNED/DRAWN: G.Siva	<b>CHENNAI METRO RAIL PROJECT PHASE - II</b>	
				TITLE : 11.KODAMBAKKAM SUBURBAN	SHEET NO : 1 of 1
DRAWING NAME : LAND PLAN SCHEDULE			SCALE : 1 : 1000		
DRAWING NUMBER : PMSPL/CMRL PII/COR 4/STN/LPS/11			DRAWN DATE : 26 - 10 - 2018		

REV.	DATE	DESCRIPTION

CGM (UG) - CMRL

This drawing is the property of Chennai Metro Rail Limited and must not be passed to any person or body not authorized by us to receive it and be copied or otherwise made use either in full or in part by such person or body without our prior permission in writing.